

USER MANUAL

ZOTAC GAMING RGB GPU SUPPORT BRACKET

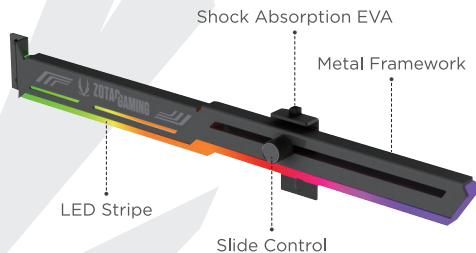

PRODUCT FEATURES



PRODUCT SPECIFICATIONS

- Function: GPU support
- Brand: ZOTAC GAMING
- Name: RGB GPU Support Bracket
- Material: Metal + ABS
- Size: 276mm x 31mm / 10.87in x 1.22in
(Cable 420mm / 16.54in)
- Color: Cool Grey
- Lighting: RGB

ZOTAC.COM

PRODUCT INTERFACES

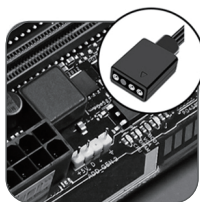

- 1 Compatible with 5V 3-Pin header* for lighting synchronization with other RGB devices, such as ZOTAC GAMING AMP Extreme Holo graphics card and motherboard.

**Not compatible to a 12V DC output*



- 2 Equipped with one 4-Pin conversion cable to allow quick connection with other RGB devices.

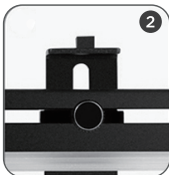

QUICK SETUP

- 1 Have all accessories ready before getting started.
- 2 Loosen and move the Slider right or left to adjust the position for the length of your graphic cards.

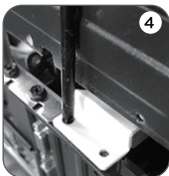

- 3 Locate and remove the screws from the PCI Support Bracket from your case. Insert the GPU Support Bracket into the available slots on the case.
- 4 Install the screws to secure the GPU Support Bracket in place.



- 5 Adjust the height of the stand (connected to the Slider) if needed until it makes contact with the GPU.
- 6 Tighten the screws to secure the bracket in place.